



HYDROFIRE ΕΠΕ

Buildings - Industry - Marine – Waterworks
END OF AG. PANTELEIMONOS Str. (ELEONAS)
GR-12241 EGALEO,
Tel.: +30 210 3412 749-750 Fax: +30 210 3412 406
www.hydrofire.gr, email: info@hydrofire.gr



Victaulic® StrengThin™ 100 System Style E497 Rigid Coupling for Stainless Steel Pipe



1.0 PRODUCT DESCRIPTION

Available Sizes

- 2 – 12"/DN50 – DN300

Pipe Material

- Designed exclusively for use on 1.4301/1.4307 (304/304L) or 1.4401/1.4404(316/316L) stainless steel pipe per EN 10217-7 or per KSD 3595.

Maximum Working Pressure

- Accommodates pressures ranging from full vacuum (29.9 in Hg/760 mm Hg) up to 232 psi/1600 kPa/16 bar.
- Working pressure dependent on wall thickness and size of pipe (see section 5.0 for Performance).

Operating Temperature Range

- Dependent on gasket selection from section 3.0.

Function

- Provides a rigid pipe joint.
- Joins EN 10217-7 stainless steel pipe and Victaulic StrengThin™ 100 fittings, valves and accessories.
- If system flexibility is required, refer to [submittal 31.08](#): Victaulic Accommodating Pipe Line Thermal Growth for StrengThin™ 100 Piping Systems for Thin Wall Stainless Steel Pipe.

Pipe Preparation

- Exclusively for use with fittings, valves, accessories and pipe which feature ends formed with the Victaulic StrengThin™ 100 groove profile (see section 7.0 for Reference Materials).

NOTE

- Coatings applied to the interior surfaces, including bolt pad mating surfaces, of Victaulic grooved and bolted plain end couplings should not exceed 0.010"/0.25 mm.

2.0 CERTIFICATION/LISTINGS



Product designed and manufactured under Victaulic's Quality Management System, as certified by LPCB in accordance with ISO-9001. Refer to section 3.0 for potable water certifications of specific gasket materials.

ALWAYS REFER TO ANY NOTIFICATIONS AT THE END OF THIS DOCUMENT REGARDING PRODUCT INSTALLATION, MAINTENANCE OR SUPPORT.





HYDROFIRE ΕΠΕ

Buildings - Industry - Marine – Waterworks

END OF AG. PANTELEIMONOS Str. (ELEONAS)

GR-12241 EGALEO,

Tel.: +30 210 3412 749-750 Fax: +30 210 3412 406

www.hydrofire.gr, email: info@hydrofire.gr



victaulic.com

3.0 SPECIFICATIONS - MATERIAL

Housing: Ductile iron conforming to ASTM A536, Grade 65-45-12; EN 1563, Grade EN-GJS-450-10; and ISO 1083, Grade JS/450-10/S.

Housing Coating: (specify choice)

- Standard: Hot dipped galvanized conforming to ASTM A153.
- Optional: Orange enamel.
- Optional: Sherardized diffused zinc coating conforming to ISO 17668.

Gasket: (specify choice¹)

Grade “EF” EPDM

EPDM (Green “X” color code). Temperature range -30°F to +230°F/-34°C to +110°C. May be specified for hot and cold water service within the specified temperature range plus a variety of dilute acids, oil-free air and many chemical services. WRAS approved material to BS 6920 for cold and hot potable water service up to +149°F/+65°C. DVGW approved material per DVGW W 270, KTW 1.3.13, and EN 681-1 Type WA cold potable and Type WB hot potable water service. NOT COMPATIBLE FOR USE WITH PETROLEUM SERVICES OR STEAM SERVICES.

Grade “T” Nitrile

Nitrile (Orange stripe color code). Temperature range -20°F to +180°F/-29°C to +82°C. May be specified for petroleum products, hydrocarbons, air with oil vapors, and vegetable and mineral oils within the specified temperature range; Not compliant for hot dry air over +140°F/+60°C and water over +150°F/+66°C. NOT COMPATIBLE FOR USE WITH HOT WATER SERVICES OR STEAM SERVICES.

¹ Services listed are General Service Guidelines only. It should be noted that there are services for which these gaskets are not compatible. Reference should always be made to the latest [Victaulic Seal Selection Guide](#) for specific gasket service guidelines and for a listing of services which are not compatible.

Bolts/Nuts: (specify choice)

- Standard: Carbon steel oval neck track bolts meeting the mechanical property requirements of ISO 898-1 Class 9.8 (M10-M16) Class 8.8 (M20 and greater). Carbon steel heavy hex nuts meeting the mechanical property requirements of ASTM A563M Class 9 (metric - hex nuts). Track bolts and heavy hex nuts are zinc electroplated per ASTM B633 ZN/FE5, finish Type III (metric).
- Optional: Stainless steel oval neck track bolts meeting the mechanical property requirements of ASTM F593, Group 2 (316 stainless steel), condition CW. Stainless steel heavy nuts meeting the mechanical property requirements of ASTM F594, Group 2 (316 stainless steel), condition CW. Bolts and nuts include galling reducing coating.

Washers: Hardened steel washers meeting ISO 7089/DIN 125.²

² Only available on 6 – 12”/DN150 – DN300 galvanized or orange enamel coated couplings and 2 – 12”/DN50 – DN300 Sherardized Diffused Zinc coated couplings.



HYDROFIRE ΕΠΕ

Buildings - Industry - Marine – Waterworks
 END OF AG. PANTELEIMONOS Str. (ELEONAS)
 GR-12241 EGALEO,

Tel.: +30 210 3412 749-750 Fax: +30 210 3412 406
www.hydrofire.gr, email: info@hydrofire.gr



victaulic.com

4.0 DIMENSIONS

Style E497 Rigid Coupling for Stainless Steel Pipe

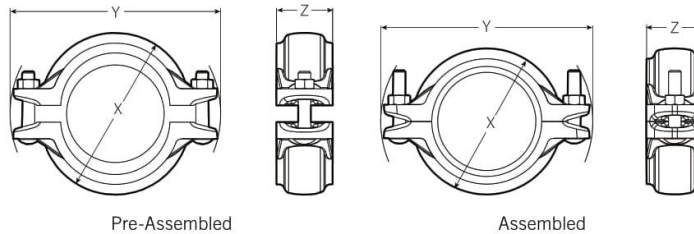

Size		Pipe End Separation	Bolt/Nut		Dimensions						Weight
Nominal inches DN	Actual Outside Diameter inches mm	Allowable inches mm	Qty.	Size mm	Pre-Assembled Condition (Installation-Ready™)			Assembled Condition			Approximate (Each) lb kg
					X inches mm	Y inches mm	Z inches mm	X inches mm	Y inches mm	Z inches mm	
2 DN50	2.375 60.3	0.25 6.4	2	M10 × 64	4.00 102	5.13 130	2.25 57	3.63 92	5.00 127	2.25 57	2.6 1.2
DN65	3.000 76.1	0.25 6.4	2	M10 × 64	4.63 118	6.25 159	2.25 57	4.25 108	6.13 156	2.25 57	2.9 1.3
3 DN80	3.500 88.9	0.25 6.4	2	M10 × 64	5.25 133	6.63 168	2.25 57	4.75 121	6.50 165	2.25 57	3.1 1.4
4 DN100	4.500 114.3	0.25 6.4	2	M10 × 64	6.50 165	8.13 207	2.25 57	6.00 152	8.00 203	2.25 57	4.3 2.0
DN125	5.500 139.7	0.25 6.4	2	M12 × 83	7.75 197	9.25 235	2.28 58	7.13 181	9.13 232	2.28 58	6.0 2.7
150A ³	165.2	0.25 6.4	2	M12 × 83	8.21 209	10.66 271	2.28 58	8.00 203	10.58 269	2.28 58	7.0 3.2
6 DN150	6.625 168.3	0.25 6.4	2	M12 × 83	8.75 222	10.36 263	2.28 58	8.25 210	10.25 260	2.28 58	7.1 3.2
200A ³	216.3	0.36 9.1	2	M16 × 108	10.93 278	13.66 347	2.92 74	10.30 262	13.52 343	2.92 74	12.0 5.5
8 DN200	8.625 219.1	0.36 9.1	2	M16 × 108	13.50 343	15.00 381	2.92 74	10.22 260	13.26 337	2.92 74	12.1 5.5
10 DN250	10.750 273.0	0.36 9.1	2	M22 × 165	17.88 454	19.00 483	2.88 73	12.50 318	17.00 432	2.88 73	22.0 10.0
12 DN300	12.750 323.9	0.36 9.1	2	M22 × 165	19.88 505	20.60 523	2.88 73	15.00 381	18.75 476	2.88 73	27.6 12.5

³ Japanese Industrial Standard (JIS) size

NOTES

- The allowable pipe end separation dimension shown is for system layout purposes only. Style E497 rigid couplings are considered rigid connections and will not accommodate expansion/contraction or angular movement of the piping system. Contact Victaulic for torsional resistance information.
- WARNING: Depressurize and drain the piping system before attempting to install, remove or adjust any Victaulic piping products.

